

Install Adobe Desktop Apps with Creative Cloud

Download Adobe Creative Cloud Desktop App

The Adobe Creative Cloud desktop app simplifies the process of installing, updating and launching Adobe desktop apps and services. The following instructions will walk you through the process of installing the Adobe Creative Cloud desktop app on your computer.

Note: Your account will need permission to install software to complete this process.

1. Open a browser and navigate to <https://www.adobe.com>.
2. Click **Sign in** at the top right corner of the page.
3. Once the *Adobe ID sign in page* loads, click **Sign in with an Enterprise ID**.

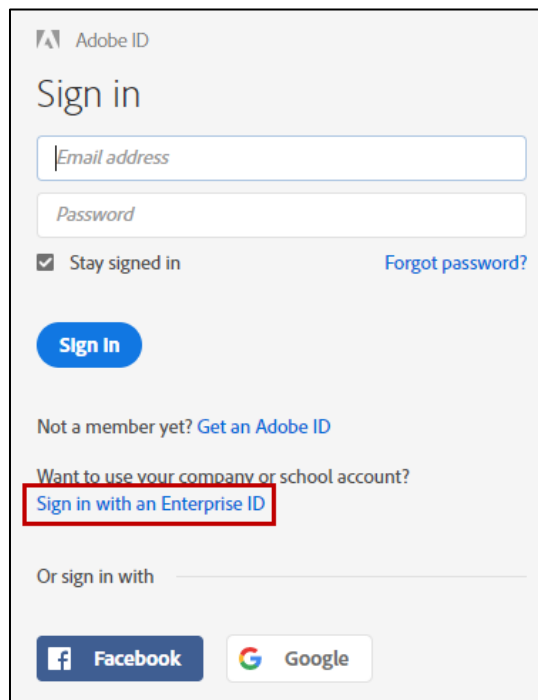

Adobe ID

Sign in

Stay signed in [Forgot password?](#)

[Sign In](#)

Not a member yet? [Get an Adobe ID](#)

Want to use your company or school account?
[Sign in with an Enterprise ID](#)

Or sign in with

[Facebook](#) [Google](#)

Figure 1 - Adobe ID Sign in Page

- When *Adobe Enterprise ID sign in page* loads, enter your **KSU email address** in the email address field and, if prompted, the password associated with your KSU email address (See Figure 2).
- Click **Sign in with an Enterprise ID** (See Figure 2).

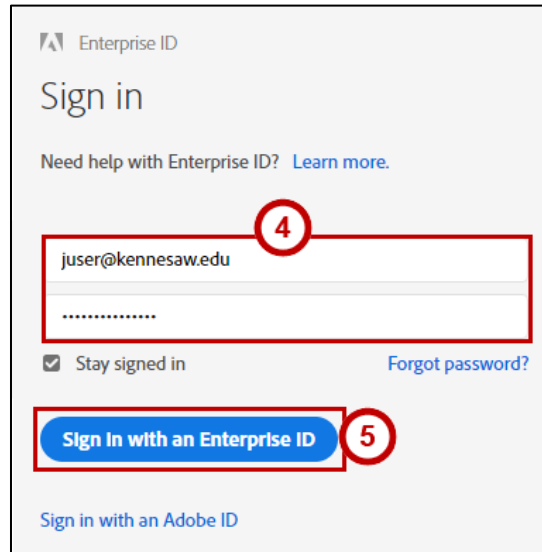

Figure 2 - Adobe Enterprise ID Sign in Page

- From the *Adobe ID Account Management Page*, click **Desktop Downloads**.

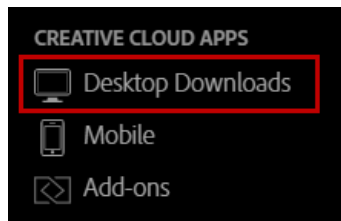

Figure 3 - Adobe ID Account Management Page

- Click the **Download** button under Creative Cloud.

Note: Once you have installed Creative Cloud, you can install programs directly from this page.

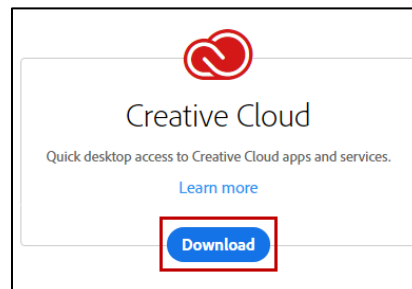

Figure 4 - Download Adobe Creative Cloud

- Wait for the install file to download. Once downloaded, follow the instructions on your browser screen to install and launch the *Creative Cloud app*.

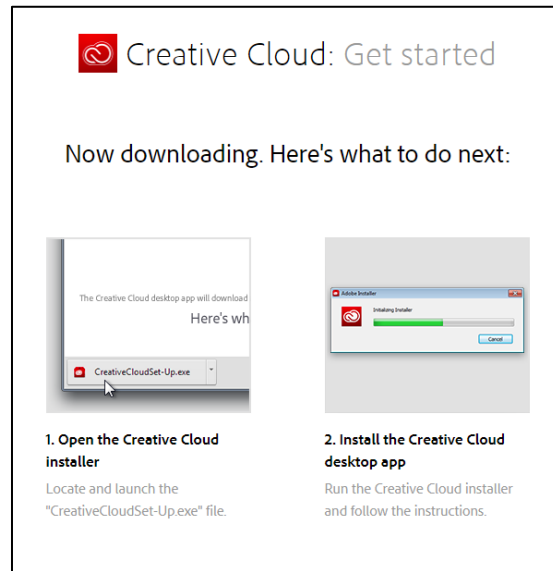

Figure 5 - Install Creative Cloud

- When the installation is complete, the Creative Cloud app opens. Click **Sign in with an Enterprise ID**.

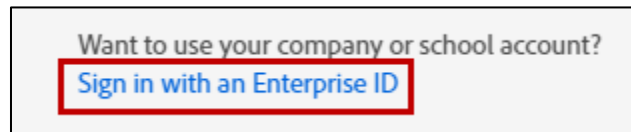

Figure 6 - Sign in with an Enterprise ID

- Enter your **KSU email address** (See Figure 7).
- Click **Sign In with an Enterprise ID**, then follow the prompts to complete signing in (See Figure 7).

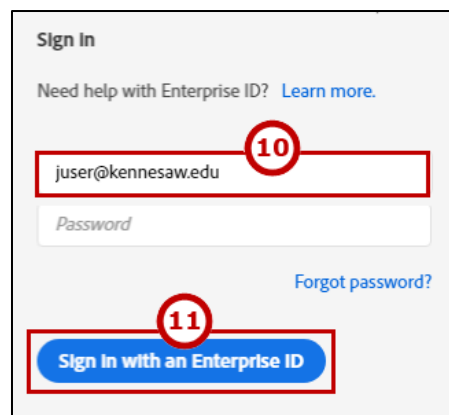

Figure 7 - Sign In

12. Once logged in, the *All Apps* tab loads. From this tab, you can install and update apps (See Figure 8).

a. To Update - Click **Update** and follow the prompts (See Figure 8).

b. To Install - Click **Install** and follow the prompts (See Figure 8).

Note: If the Apps tab does not display a list of apps, reboot your computer.

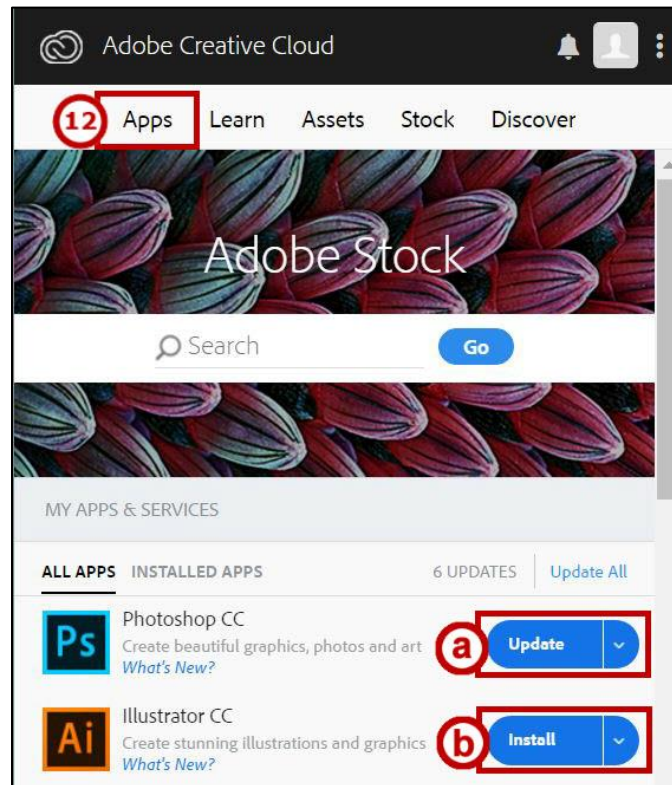

Figure 8 – Creative Cloud Apps Tab