

The following guide walks you through connecting to the KSU WiFi using Windows 10.

Note: This documentation was created using a Windows Surface tablet.

1. Click the **WiFi icon** from the system tray in the lower right corner of the screen.

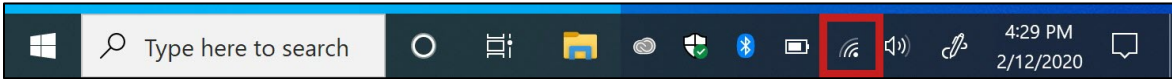

Figure 1 - Click WiFi Icon

2. The list of available wireless networks appears. Click **Wi-Fi** (See Figure 2).
3. Click **KSU** (See Figure 2).

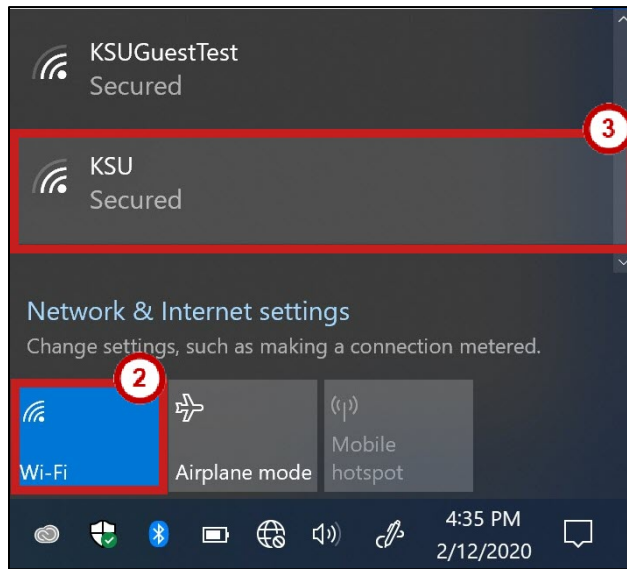

Figure 2 - Click WiFi, then Click KSU

4. Click **Connect**.

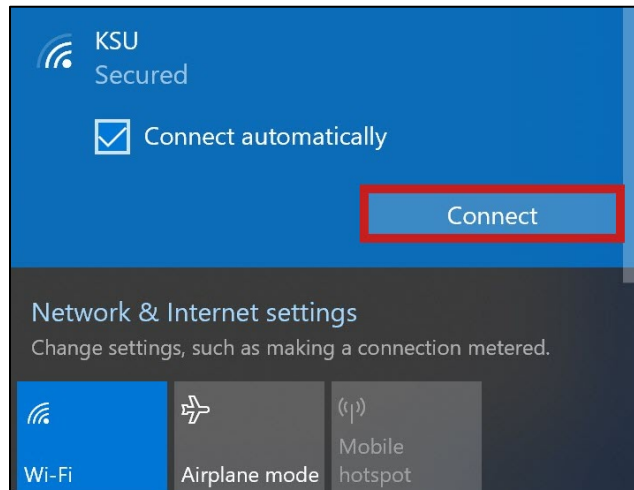

Figure 3 - Click Connect

5. The *Windows Security* window will open. Enter:
 - a. **NetID** (See Figure 4)
 - b. **NetID Password** (See Figure 4)
6. Click **OK** (See Figure 4).

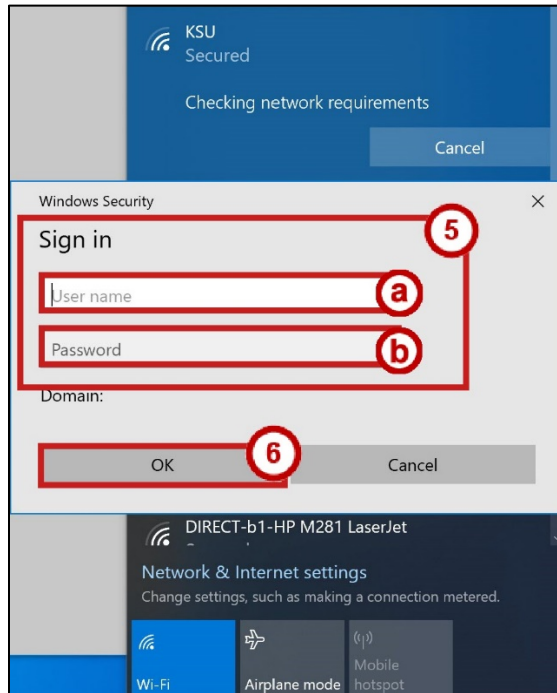

Figure 4 - Enter NetID and Password and Click OK

7. You will be asked to verify the connection. Click **Connect**.

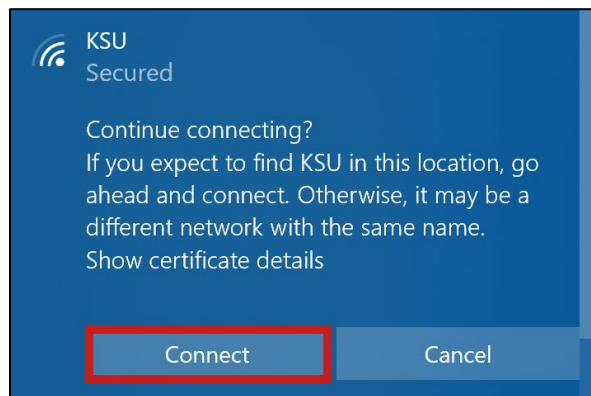

Figure 5 - Click Connect.

8. You are now connected to KSU WiFi.