

The following guide walks you through connecting to the KSU WiFi with MacOS.

Note: This documentation was created using a MacBook Pro running Mojave software version 10.14.3.

1. To access the *WiFi Settings*, click the **Wi-Fi menu** icon on the *Menu bar* of your device (See Figure 1).
2. Make sure that *Wi-Fi* is turned on; if not, click **Turn Wi-Fi On** (See Figure 1).

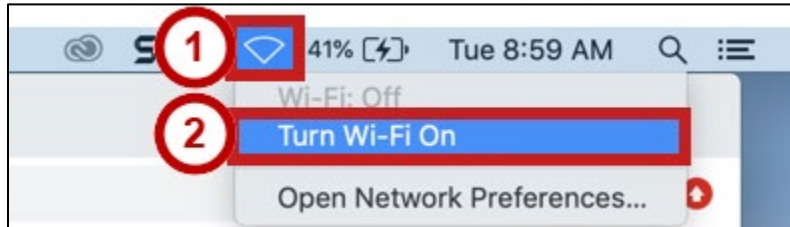

Figure 1 - Turn Wi-Fi on

3. Click **KSU**.

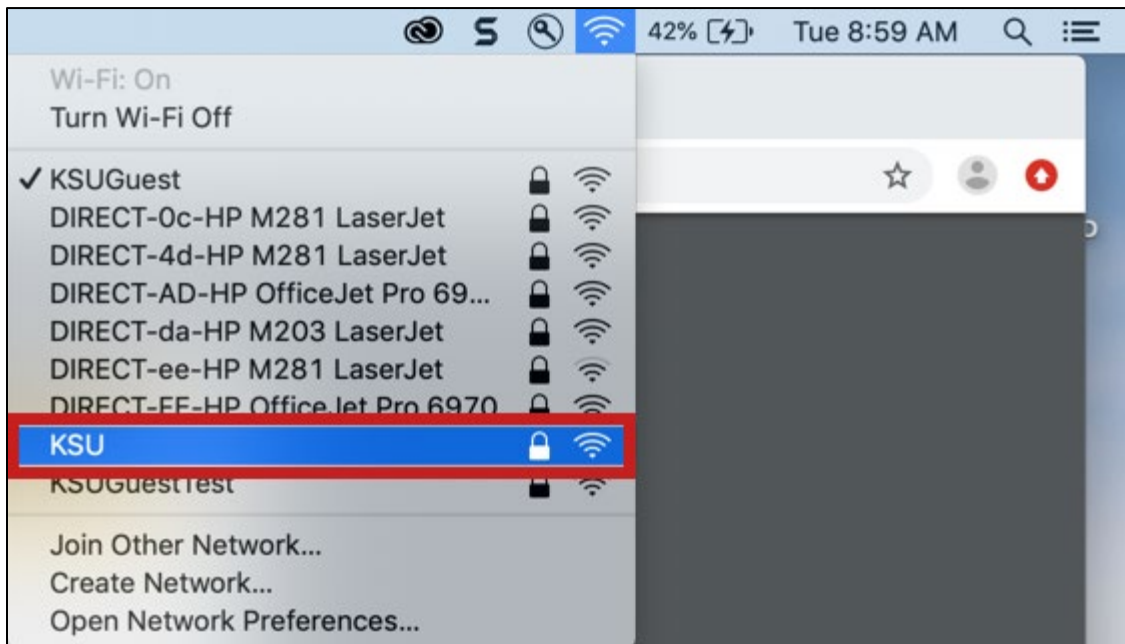

Figure 2 - Click KSU

4. The *KSU WiFi - Login* dialog box will open. Enter:
 - a. **NetID** (See Figure 3)
 - b. **NetID Password** (See Figure 3)
5. Click **Join** (See).

Note: Click the checkbox beside *Remember this network* to connect automatically in the future.

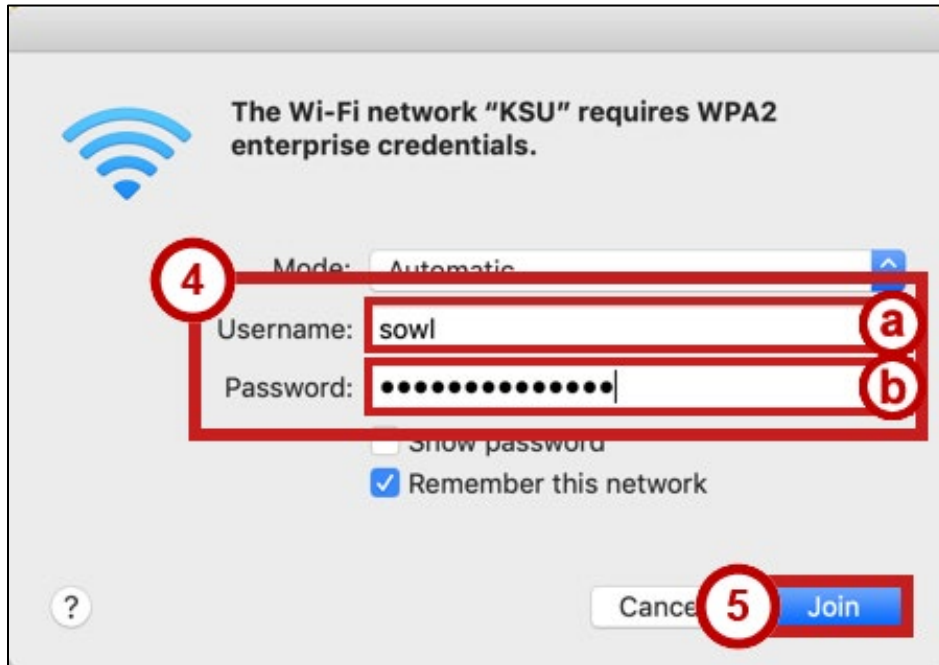

Figure 3 - Enter NetID and Password and click Join

6. The *Verify Certificate* window will open. Click **Continue**.



Figure 4 - Click Continue

7. The *Certificate Trust Settings* dialog box will open. Enter:
 - a. **NetID** (See Figure 5)
 - b. **NetID Password** (See Figure 5)
8. Click **Update Settings** (See Figure 5).

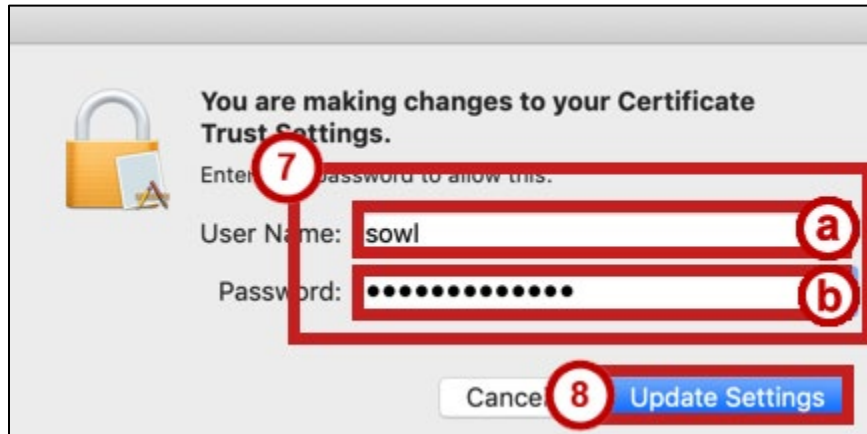

Figure 5 - Enter NetID and Password and click Update Settings

9. You are now signed into the KSU WiFi.



Figure 6 - Connected to KSU Wi-Fi